

REV	DATE	DESCRIPTION	APPROVAL
A	2018/03/28	1. ADDED CG SYMBOLS TO SIDE AND BACK VIEWS. 2. ADDED INTERFACING CONNECTOR INFO TO BACK VIEW. 3. TRANSFERRED OPERATING TEMPERATURE LIMIT TO DRAWING BC462-SPEC. 3. TRANSFERRED OPERATING SPEED LIMIT TO DRAWING BC462-SPEC.	DRAWN B.MUSSER CHECKED N.BAINBRIDGE APPROVED N.BAINBRIDGE

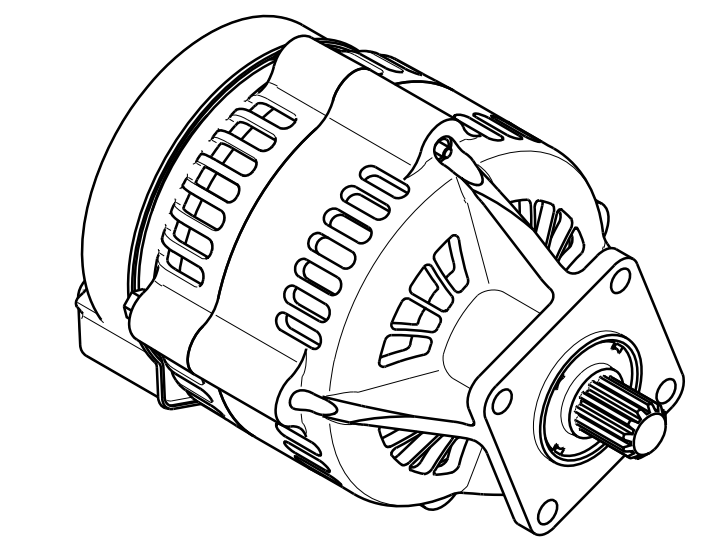
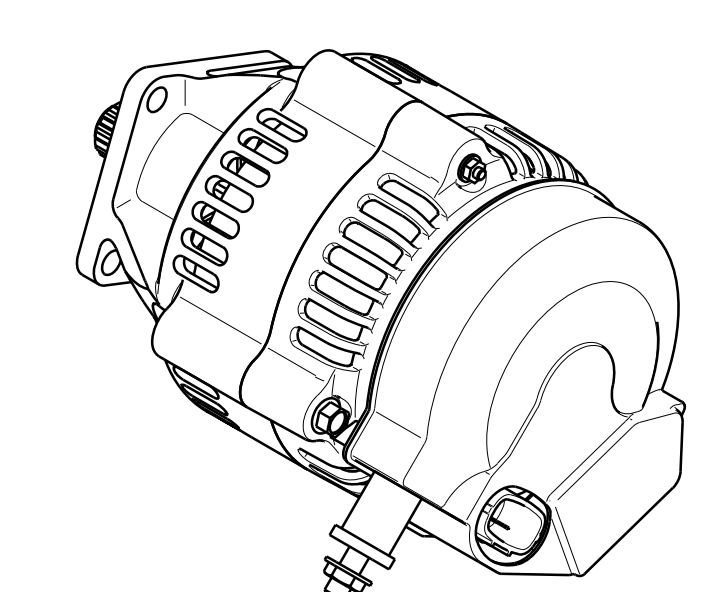
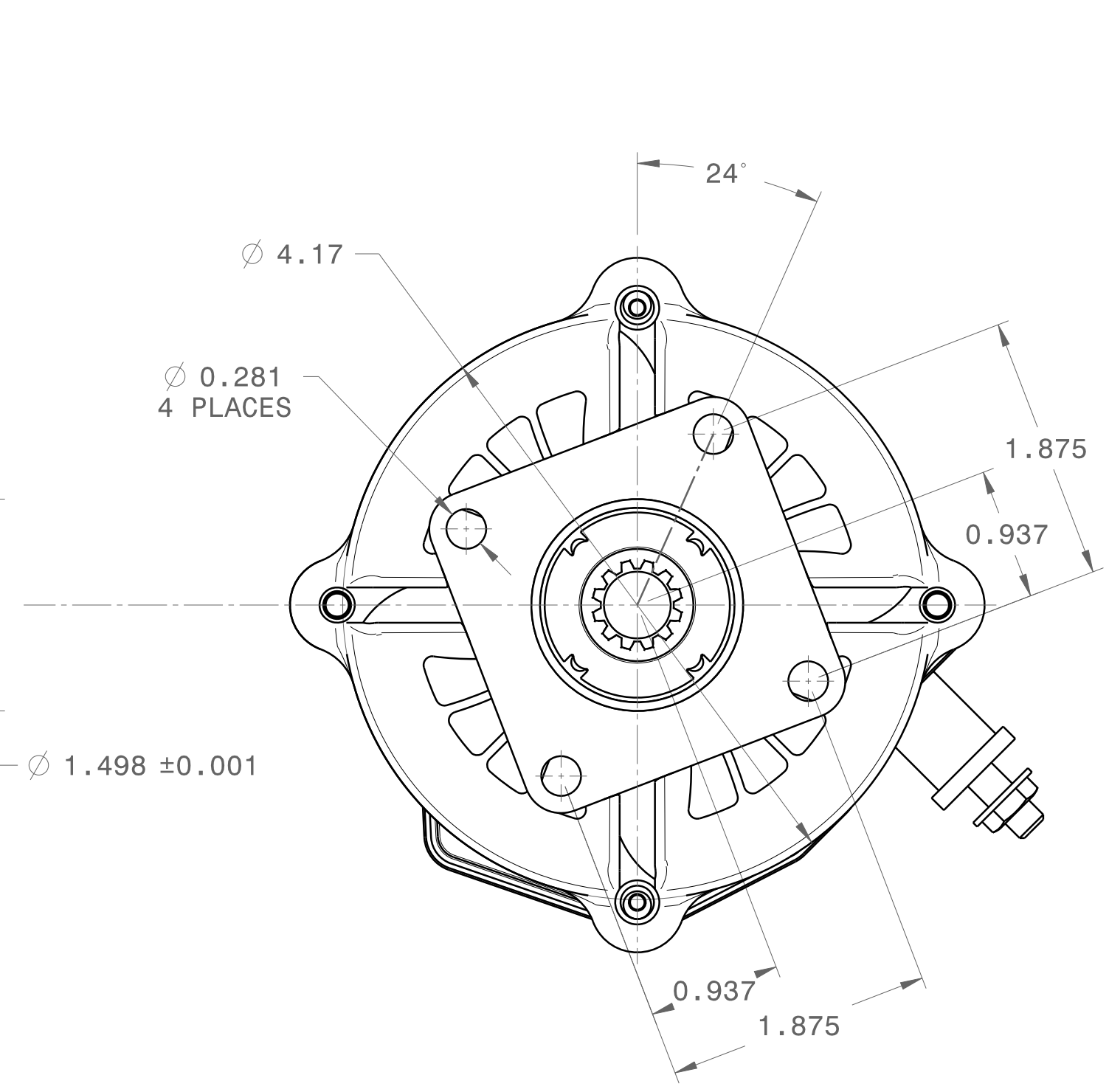
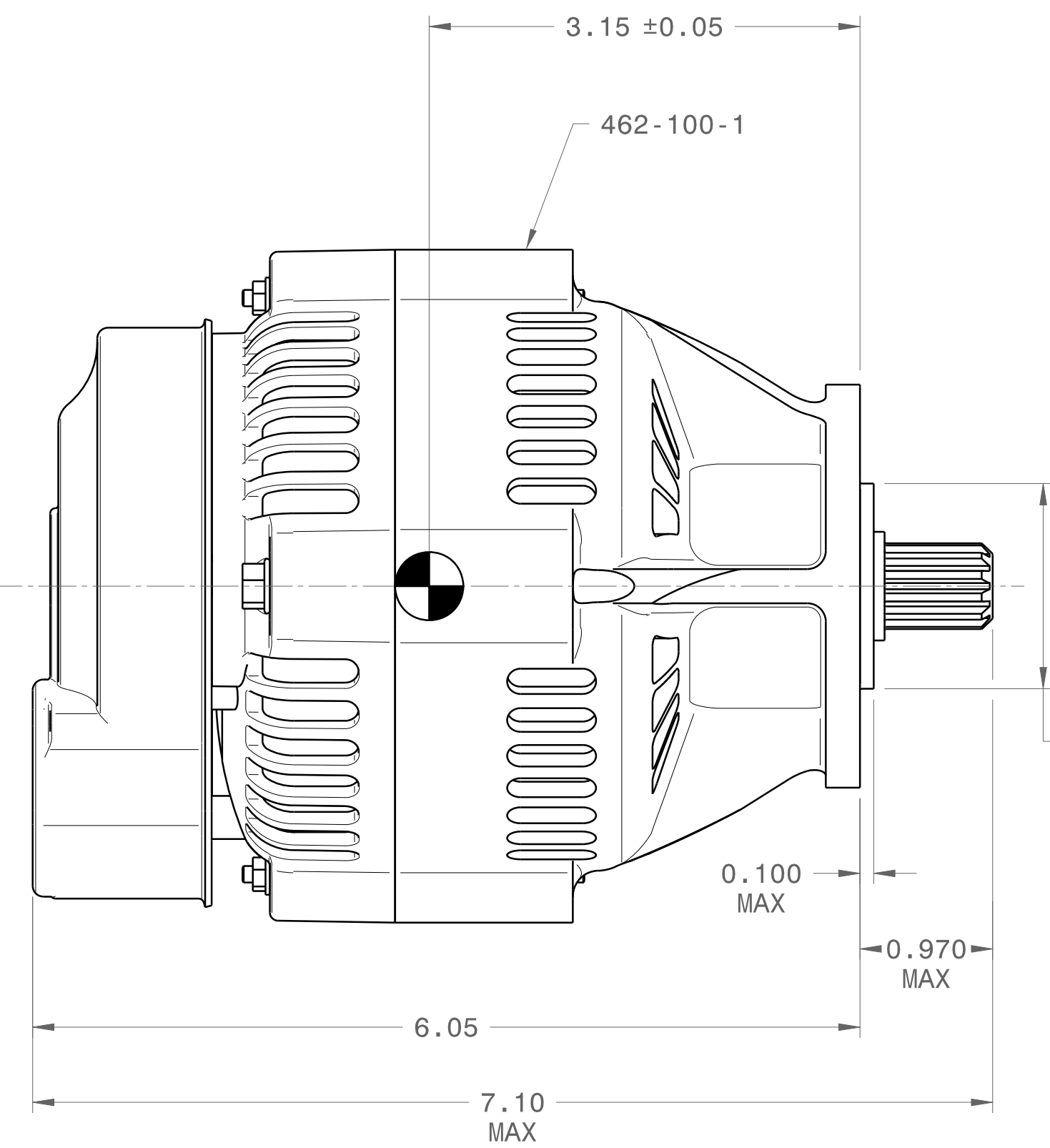
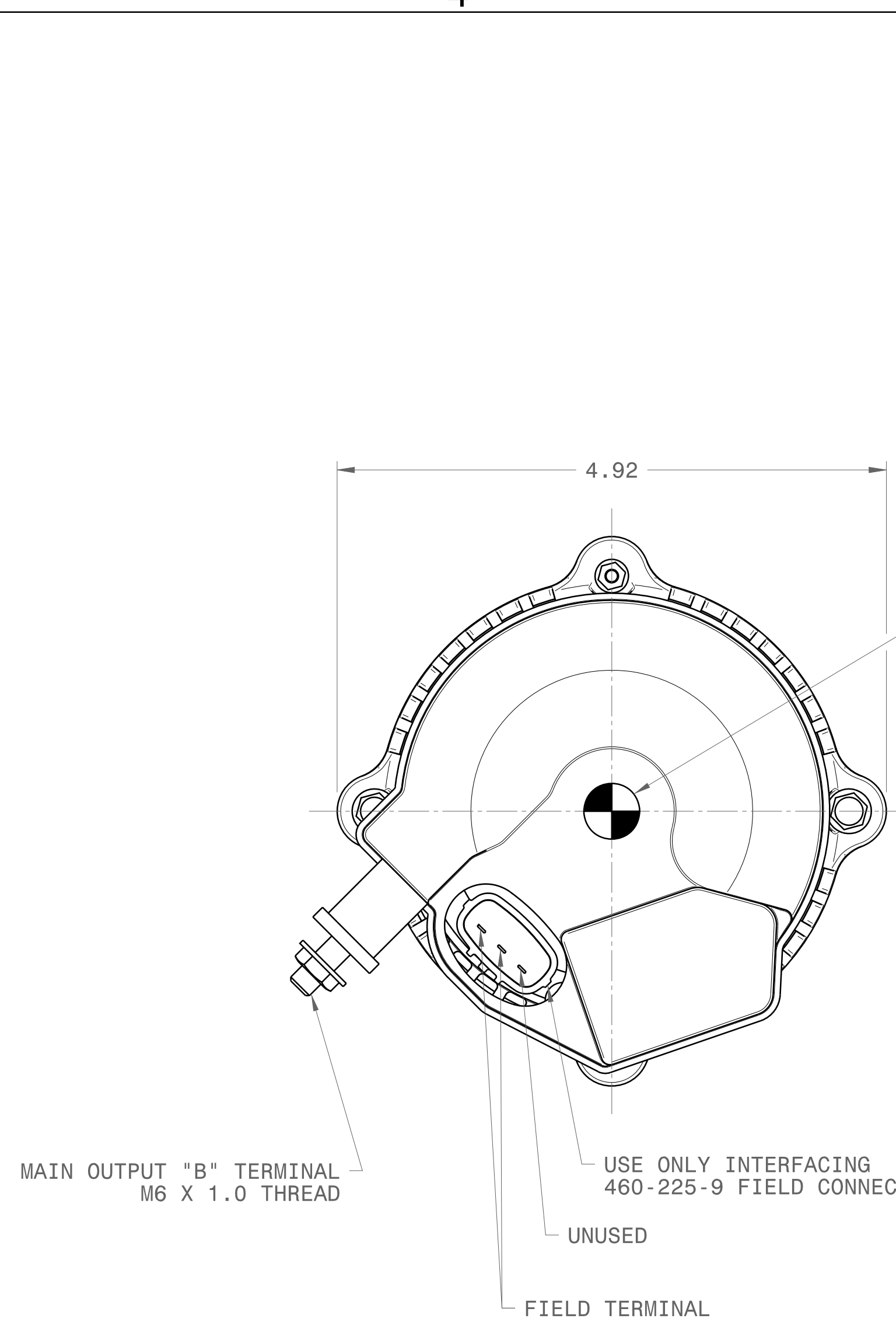

-1 ALTERNATOR
SIDE VIEW
SCALE 1:1

-1 ALTERNATOR
INFORMATION
FOR USE ON AND20000 ACCESSORY PAD
WEIGHT: 6.8 LBS

USED ON	PART NUMBER	DESCRIPTION	NOTES
1	462-100-1	ALTERNATOR ASSEMBLY	
-	-1	ALTERNATOR	
-1			

B&C SPECIALTY PRODUCTS
Newton, Kansas

DRAWING TITLE
**ENVELOPE & INTERFACE
AIRCRAFT ALTERNATOR,
14/28 VOLT, 60 AMP**

DRAWN BY
B.MUSSER

CHECKED BY
N.BAINBRIDGE

APPROVED BY
N.BAINBRIDGE

DATE
2017/05/22

DATE
2017/05/23

DATE
2017/05/23

SIZE
D

DRAWING NUMBER
BC462-H

REV
A

SCALE
1:1

WEIGHT(lb)
-

SHEET
1 OF 1

- NOTES:
- ALL DIMENSIONS FOR REFERENCE ONLY.
 - RECOMMENDED OVERHAUL INTERVAL IS 1,700 HOURS.

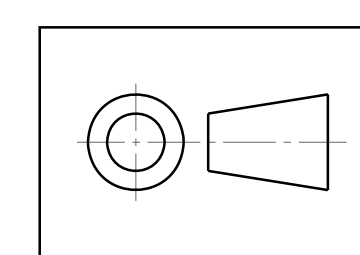

This drawing is the property of B&C Specialty Products. Neither this drawing nor any information contained herein may be copied, distributed or reproduced without express written consent from B&C Specialty Products.